

# WHY ARE WE LOOKING FOR THE TEMPLE?

- The temple was destroyed in 70 AD and all attempts to rebuild it, thus far, have failed.
- But God's word clearly indicates that another temple would be rebuilt in the last days—when the Jews were again regathered to the land of Israel...
- Consequently, people have been trying to determine its former location in anticipation of seeing it rebuilt

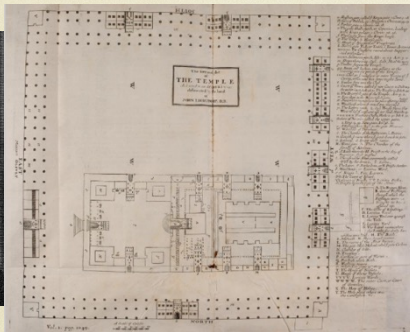

John Lightfoot (1684)

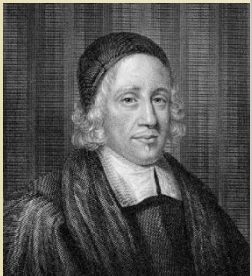
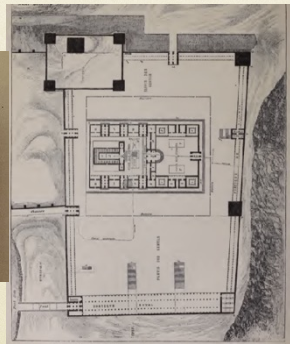

Melchior de Vogue (1864)

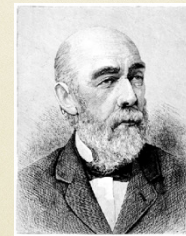

James Fergusson (1878)

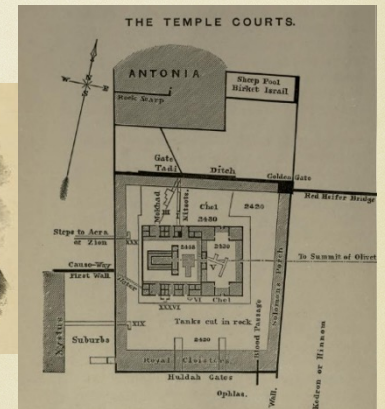
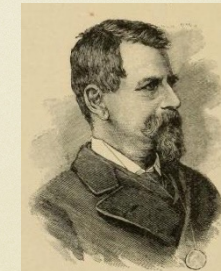

Charles Warren (1884)



# ISRAEL REGATHERED IN THE LAST DAYS

*Then it will happen **on that day** that the Lord will again recover with His hand **the second time** the remnant of His people who will remain, from Assyria, Egypt, Pathros, Cush, Elam, Shinar, Hamath, and from **the islands of the sea**. — Isaiah 11:11*

- The first regathering was with Ezra and Nehemiah when the temple was first rebuilt (c. 516-409 B.C.)
- The phrase “a second time” is OUR TIME and “on that day” refers to the Last Days.





# THE PROMISE TO REBUILD

*The Lord rebuilds Jerusalem;  
He gathers Israel's exiled  
people. – Psalm 147:2*

*Then the nations around  
you that remain will know  
that I the Lord have rebuilt  
what was destroyed and  
have replanted what was  
desolate. I the Lord have  
spoken, and I will do it.' –  
Ezekiel 36:36*

1898



2011





# IN BOTH THE OLD & NEW TESTAMENTS

- In the book of Ezekiel (ch. 45-48), a temple is described that seems best understood as being built during the millennial reign of Christ.

Then the nations will know that I the LORD make Israel holy, **when my sanctuary is among them forever.** – Ezekiel 37:28

- And we are told that God's temple will also be profaned by the Antichrist in the last days.

He will oppose and will exalt himself over everything that is called God or is worshiped, **so that he sets himself up in God's temple,** proclaiming himself to be God. – 2 Thessalonians 2:4



# WHERE WAS THE JEWISH TEMPLE?

## On the Temple Mount

1. The Dominant Belief: at the Dome of the Rock location
2. NORTH of the Dome (at the Dome of the Spirits)
3. SOUTH of the Dome (at the al-Kas Fountain)

4. City of David
5. Various other spurious proposals

Very poor evidence that it could have been outside the Temple Mount



# THE TESTIMONY ABOUT THE EAST GATE

## Ezekiel 44:1-2

Then the man brought me back to the outer gate of the sanctuary, the one facing east, and it was shut. The Lord said to me, "This gate is to remain shut. It must not be opened; no one may enter through it. It is to remain shut because the Lord, the God of Israel, has entered through it."



Golden Gate viewed from the southeast



# ALL THE TEMPLE GATES WERE ALIGNED

- This is seen in the design of the tabernacle and the temple described in Ezekiel, all of which are a copy of the heavenly temple/tabernacle.

They serve at a sanctuary that is a copy and shadow of what is in heaven. This is why Moses was warned when he was about to build the tabernacle: “See to it that you make everything according to the pattern shown you on the mountain. – Hebrews 8:5

- The Mishnah records this as well.

One should not show disrespect to the Eastern Gate, because it is in direct line with the holy of holies. – Mishnah Berakhot 9:5



# FURTHER COMMENTARY SHOULD ERASE ANY DOUBT

**All of the gates were aligned with one another:** the eastern gate (the Golden Gate – the eastern gate of the outer sanctuary), the gate of the ezrath nashim (Court of the Women), the gate of the ezrath Yisrael (Court of Israel), the entrance of the Ullam (Entrance Hall), the sanctuary, and the holy of holies—in the days of the First Temple. – Commentary on Mishnah Berakot 9:5 by Rabbi Bartenura (c. 1445-1515)





Second Temple Model – The Israel Museum, Jerusalem



NORTHERN  
GATEPOST



SOUTHERN  
GATEPOST

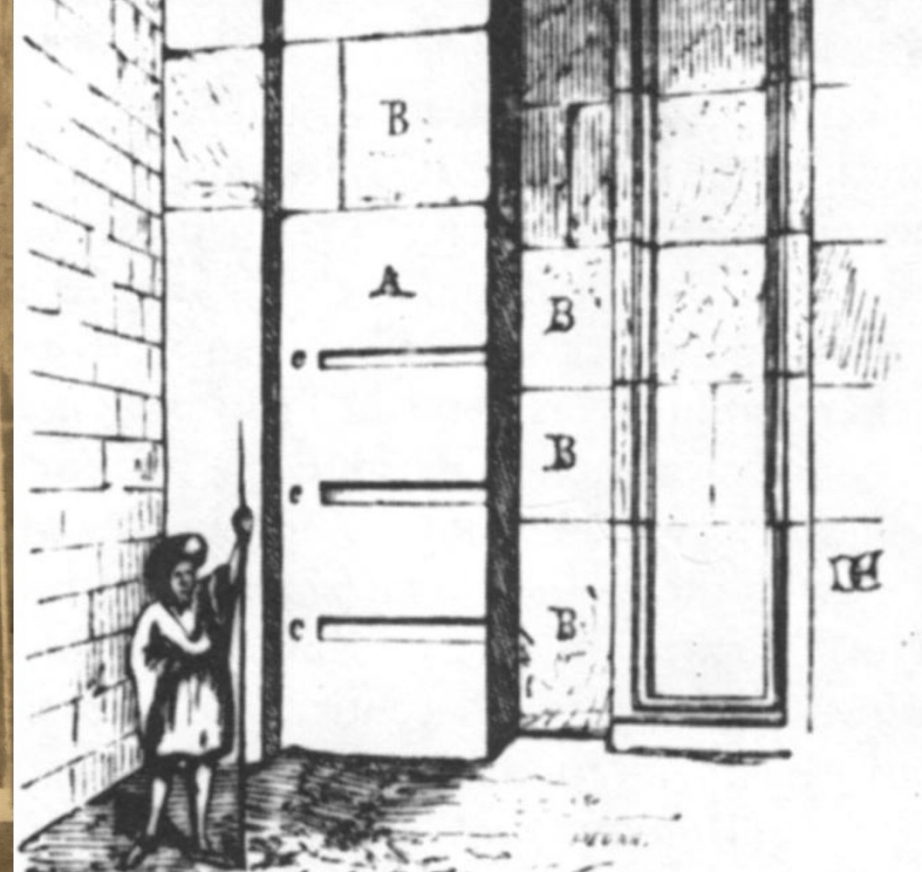



These monolithic gateposts may have been part of the earliest wall section of the Temple Mount walls. Even if they were inserted at a later date, it follows that as no remains of any other pre-Herodian eastern gateway are known, the site of the Golden Gate is the only possible location for the earlier Shushan Gate.

–Dr. Leen Ritmeyer, ***The Quest***, 178.

[Note: *The Shushan Gate was the name of the eastern gate of the outer sanctuary in the time of the Second Temple.*]



**A POOR PLACE FOR A GATE UNLESS IT  
MUST BE ALIGNED WITH THE TEMPLE...**





# THE SEARCH FOR THE TEMPLE SHOULD BEGIN WITH THE THRESHING FLOOR...

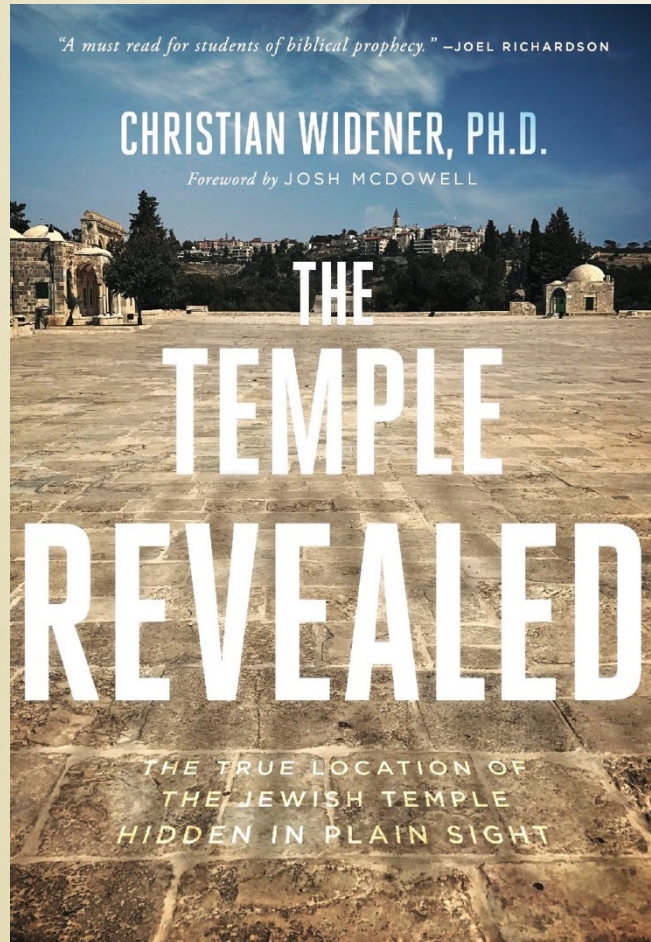

THE TEMPLE REVEALED COVER

Then Solomon began to build the temple of the Lord in Jerusalem on Mount Moriah, where the Lord had appeared to his father David. It was on the threshing floor of Araunah the Jebusite, the place provided by David.  
– 2 Chronicles 3:1



DOME OF THE SPIRITS



# WHAT WAS A THRESHING FLOOR?



Threshing Sledge (Museum of the Bible)



Threshing Grain with a Sledge



The image is a composite of two photographs of an ancient threshing floor. The left photograph shows a corner of the floor with several stone columns and a low stone wall. The right photograph is a close-up of the floor surface. Green arrows point from text boxes to specific features: one points to a recessed area in the left photo, and another points to the floor surface in the right photo.

The threshing floor  
bedrock surface has  
been cut down

The bedrock here is flat  
and smooth but chipped



## WHAT ABOUT THE DOME OF THE ROCK?

The large piece of  
bedrock (al-Sakhra)  
inside the Dome of  
the Rock is not flat,  
*like a threshing  
floor*, and never  
could have been...





# THE CUT FOR HADRIAN'S TEMPLE

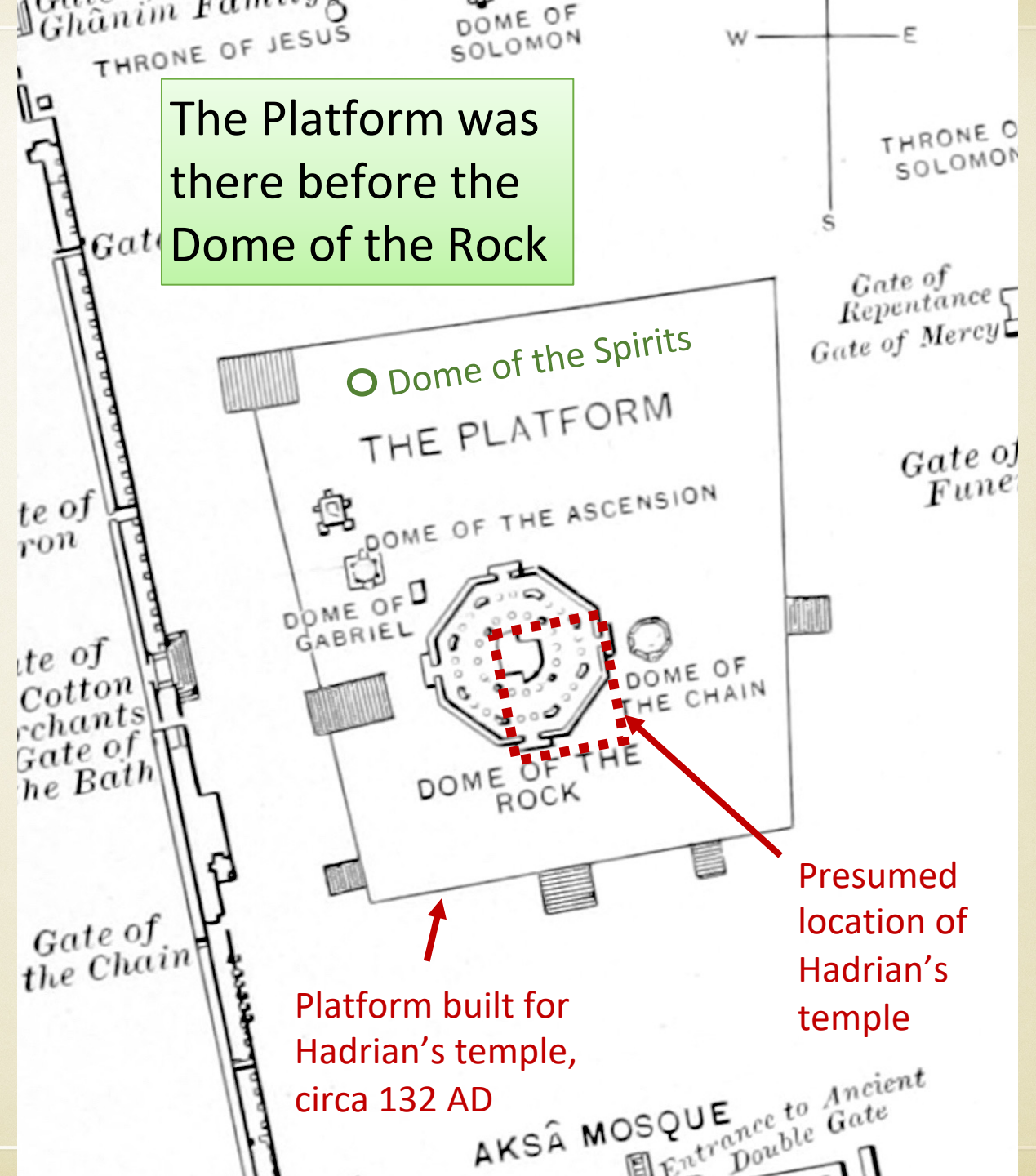
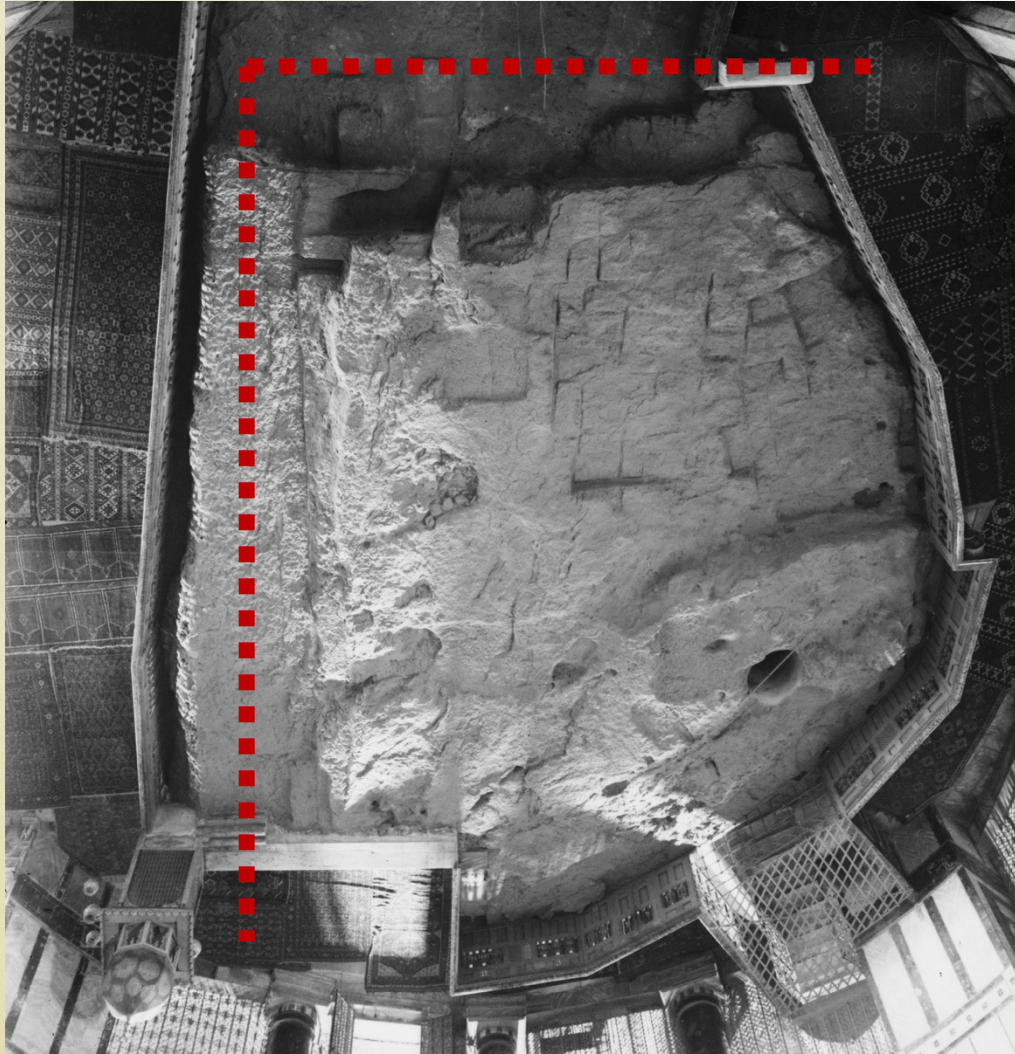



# WITH TWO JUST LANDMARKS— THE CASE IS CLOSED

- Historic reports and archaeology confirm the ancient origins of the Golden Gate.
- The East Gate was directly in line with the temple, as recorded in the Mishnah.
- A flat piece of bedrock that predates the current platform is directly in line with the Golden Gate—99.93% chance this is no accident!

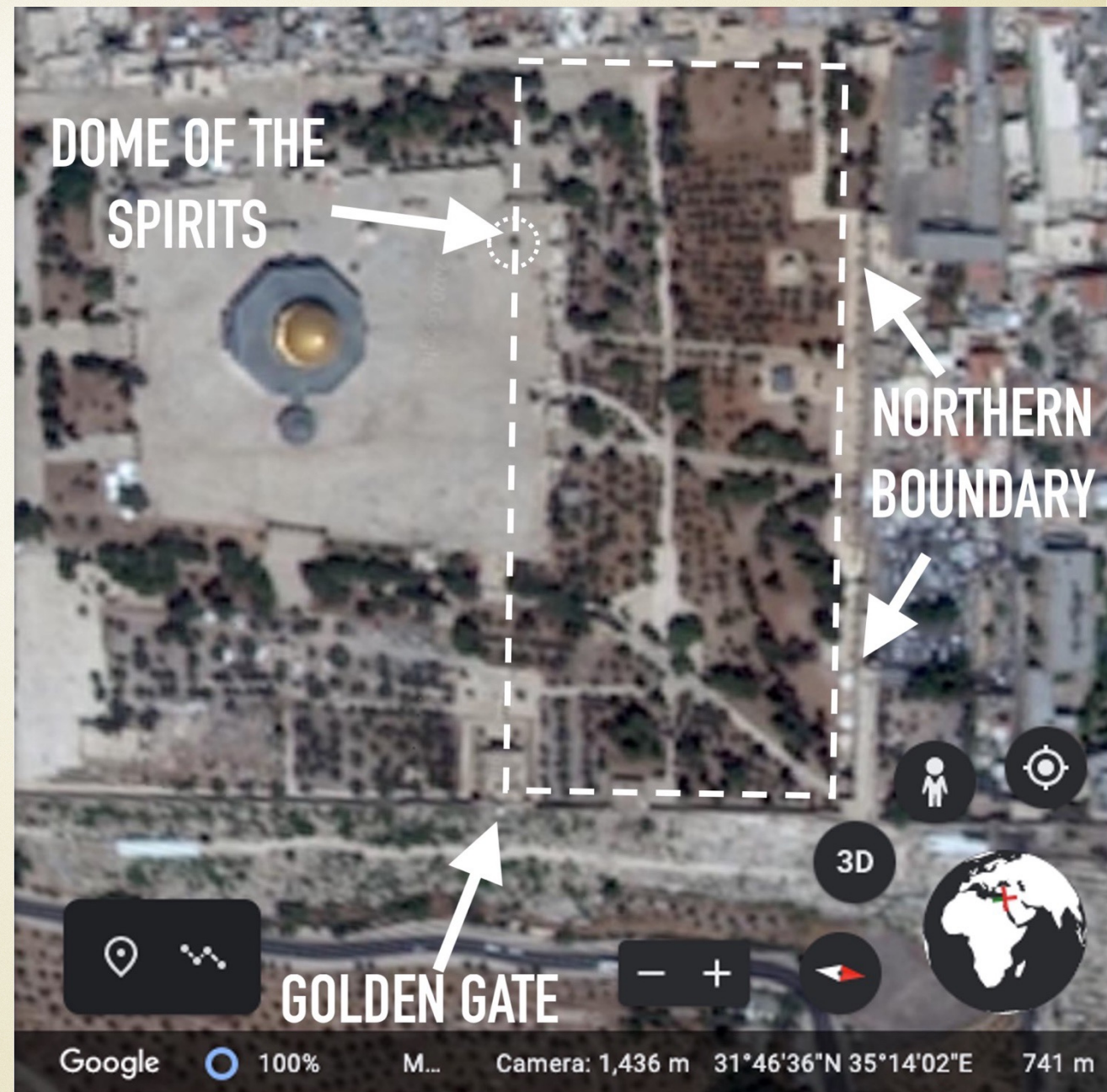

Alignment of the threshing floor and Golden Gate



# GOD'S CHOSEN SPOT

And He said: “Son of man,  
**this is the place of my throne  
and the place for the soles of  
my feet.** This is where I will live  
among the Israelites forever.”  
– Ezekiel 43:7

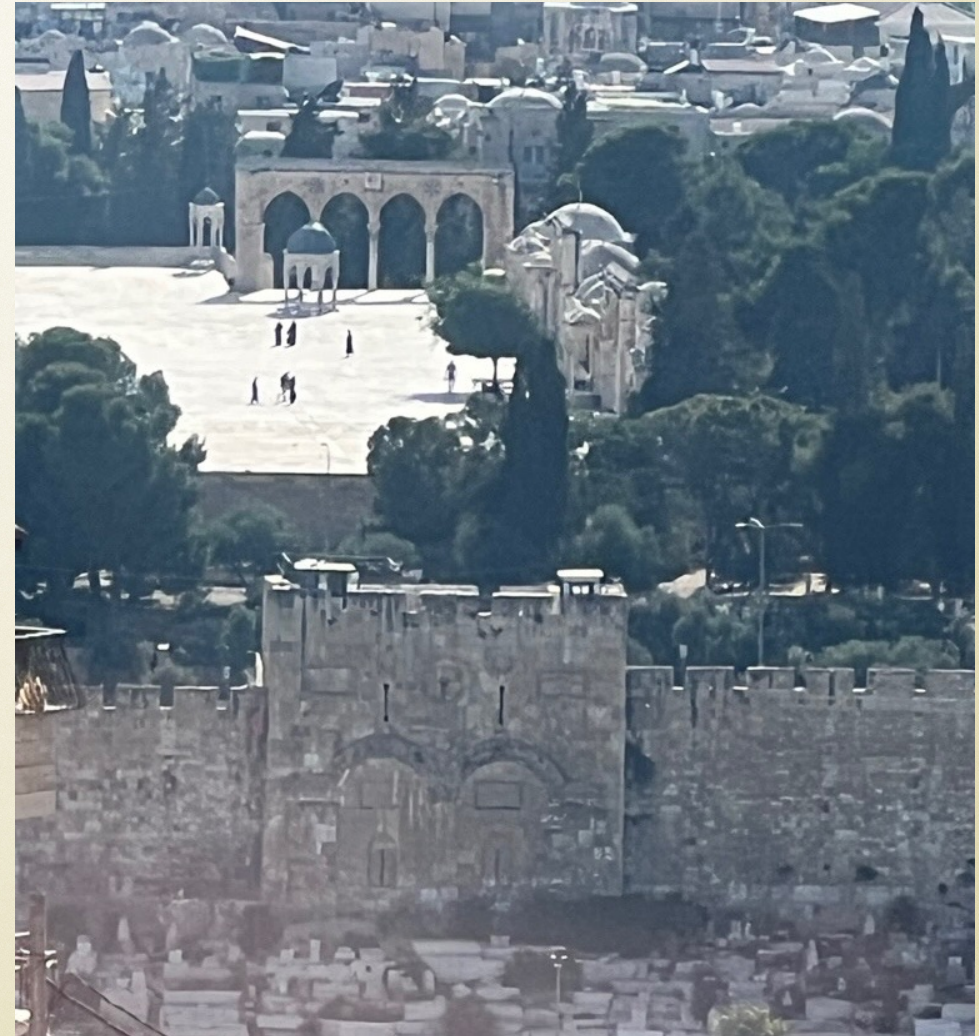



When they placed their threshold next to my threshold and their doorpost next to my doorpost, with only the wall between me and them... – Ezekiel 43:8

Leave out the court which is outside the temple and do not measure it, for it has been given to the nations... – Rev. 11:2

## ADJACENT BUILDINGS



PROPOSED TEMPLE LAYOUT



## EAST AND SOUTH GATES SURVIVED

And now the Romans, judging that it was in vain to spare what was round about the holy house, burnt all those places, as also the remains of the cloisters **and the gates, two excepted; the one on the east side, and the other on the south;** both which, however, they burnt afterward.

--Josephus, *Wars of the Jews* (6,5,2)





The gate Beautiful  
where Peter and John  
healed a lame man  
(Acts 3)





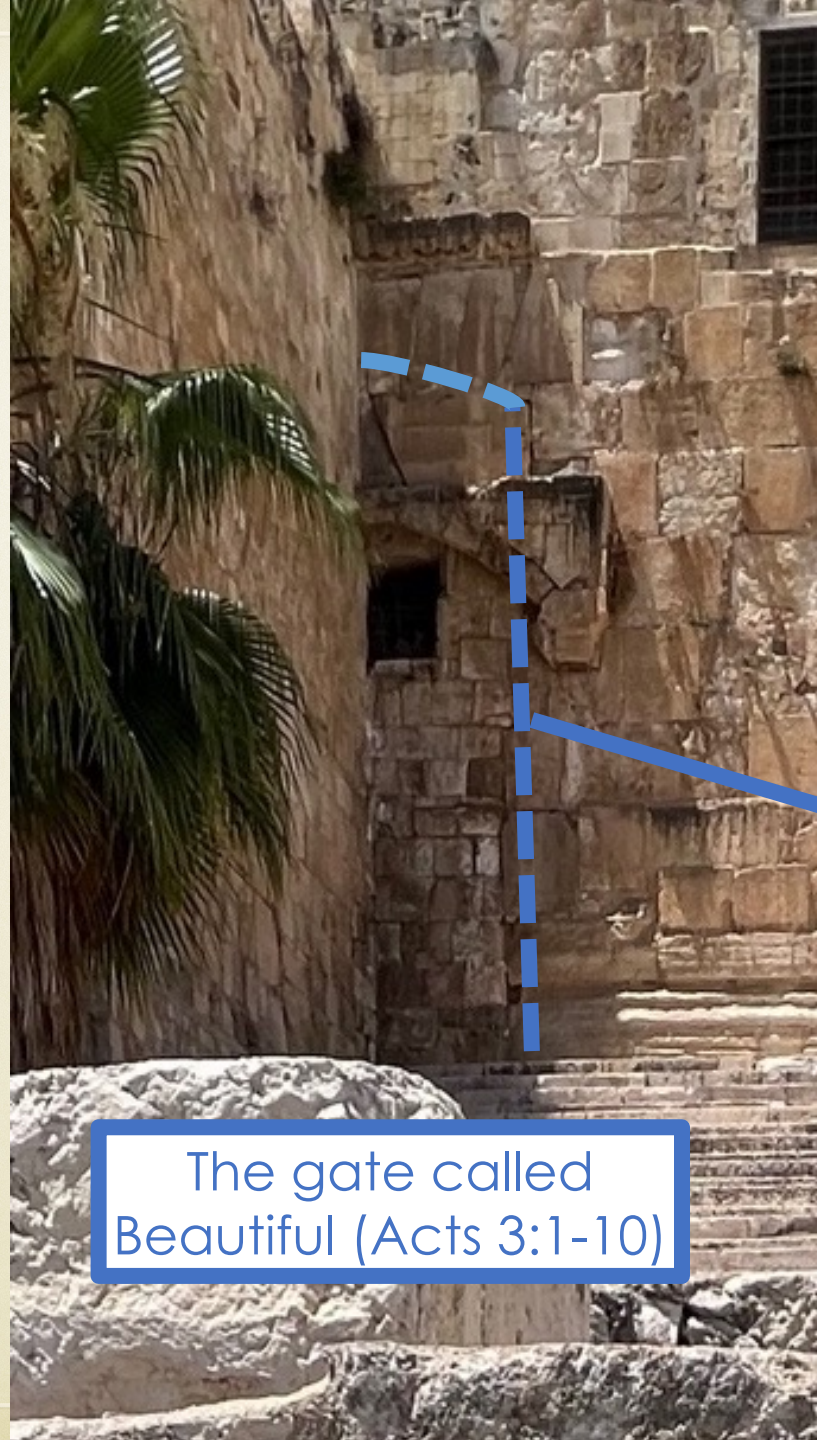

The gate called  
Beautiful (Acts 3:1-10)

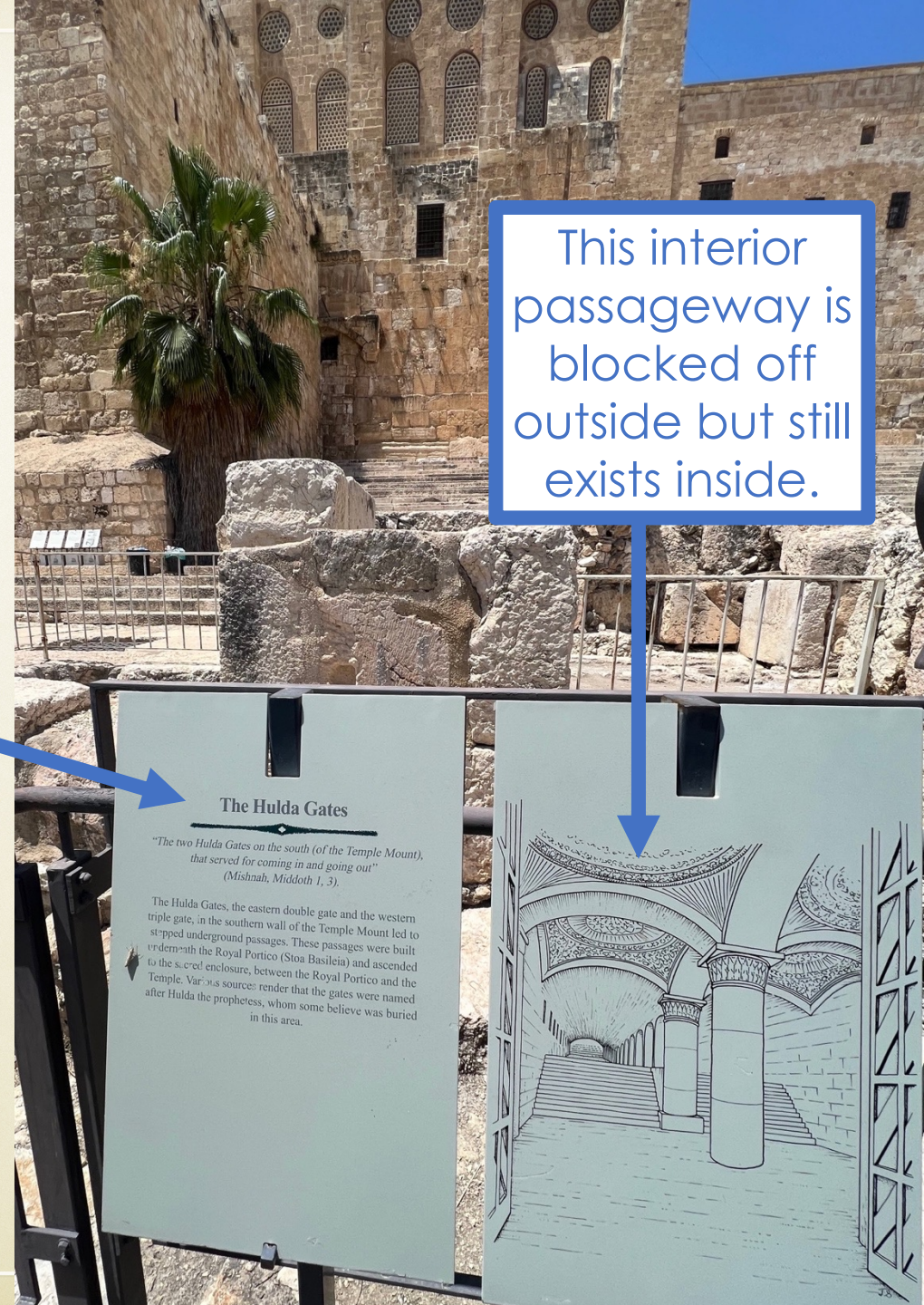

This interior  
passageway is  
blocked off  
outside but still  
exists inside.

### The Hulda Gates

*"The two Hulda Gates on the south (of the Temple Mount),  
that served for coming in and going out"  
(Mishnah, Middoth 1, 3).*

The Hulda Gates, the eastern double gate and the western triple gate, in the southern wall of the Temple Mount led to stepped underground passages. These passages were built underneath the Royal Portico (Stoa Basileia) and ascended to the sacred enclosure, between the Royal Portico and the Temple. Various sources render that the gates were named after Hulda the prophetess, whom some believe was buried in this area.

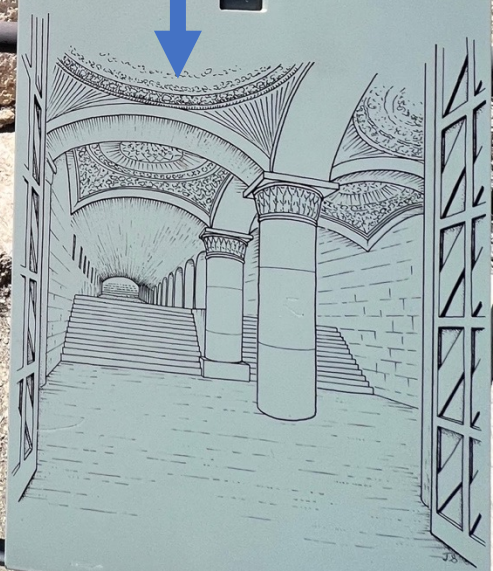



# BEST PARTS OF JERUSALEM SPARED

Now, as soon as the army had no more people to slay or to plunder... Caesar gave orders that they should now demolish the entire city and temple, **but should leave as many of the towers standing as were of the greatest eminency**; that is, Phasaelus, and Hippicus, and Mariamne, and so much of the wall as enclosed the city on the west side. **This wall was spared**, in order **to afford a camp for such as were to lie in garrison**; as were the towers also spared, in order to demonstrate to posterity what kind of city it was, and how well fortified, which the Roman valor had subdued.

—Josephus, Wars, 7,1,1



# AFTER THE DESTRUCTION, THE 10<sup>TH</sup> LEGION STAYED TO GUARD JERUSALEM

But (Titus) permitted the tenth legion to stay, as a guard at Jerusalem... – Josephus, Wars, 7,1,3



# ROMAN LEGION FORTIFICATIONS AT MASADA





In *Wars of the Jews* (5,5,8), Josephus says there was a Roman legion stationed at the Fortress Antonia... but we know from both the New Testament and Roman records that he misspoke and meant a cohort.

*The soldiers took Him away into the palace (that is, the Praetorium), and **they called together the whole Roman cohort.*** – Mark 15:16





Western Wall Area Now  
Exposed Below Ground





# TEMPLE MOUNT VS. PYRAMID OF GIZA



- **The Temple Mount** is about 300 m x 475 m x 25 m, this equals  $3,562,500 \text{ m}^3$
- The largest stone is 13.5 m x 3.3 m x 2 m and weighs over 250 tons!



- **The Great Pyramid at Giza** has a volume of  $2,650,000 \text{ m}^3$
- Its largest stone is not more than 80 tons.



# WAS THERE “LIVING WATER” ON THE TEMPLE MOUNT?

- Yes. The Temple Mount has millions of gallons of water in interconnected cisterns that were supplied with fresh flowing water (like mikvahs) from two aqueducts, one coming from the Pools of Solomon about 13 km away.
- The Mishnah records that water was brought up from the cisterns using wheels to serve the Temple.

In the chamber of the exile there was a fixed cistern, with a wheel over it, and from there water was provided to all of the courtyard. – Mishnah Middot 5:4



# Solomon's Pools





# THE ARK WAS BROUGHT UP FROM THE CITY OF DAVID

After David had constructed buildings for himself in the City of David, he prepared a place for the ark of God and pitched a tent for it. – 1 Chronicles 15:1

Then Solomon summoned to Jerusalem the elders of Israel, all the heads of the tribes and the chiefs of the Israelite families, to bring up the ark of the LORD's covenant from Zion, the City of David... The priests then brought the ark of the LORD's covenant to its place in the inner sanctuary of the temple, the Most Holy Place, and put it beneath the wings of the cherubim. – 2 Chronicles 5:2,7





Temple Mount

City of David



# TEMPLE MOUNT

True temple location

Golden Gate

Other proposed temple locations

Area that was built up to create a platform

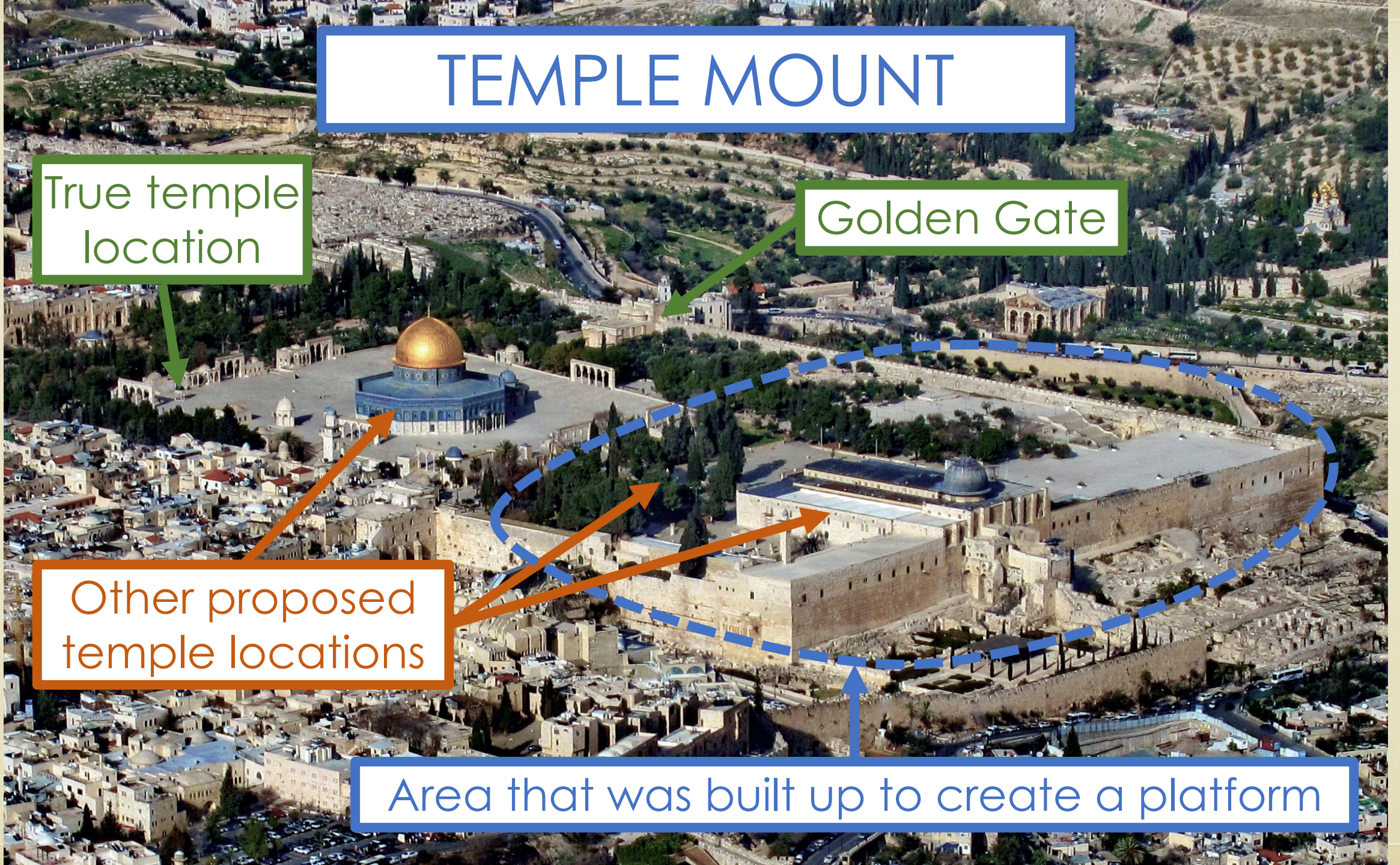



# EXCAVATIONS AT SOLOMON'S STABLES PERFORMED BY JORDANIAN WAQF

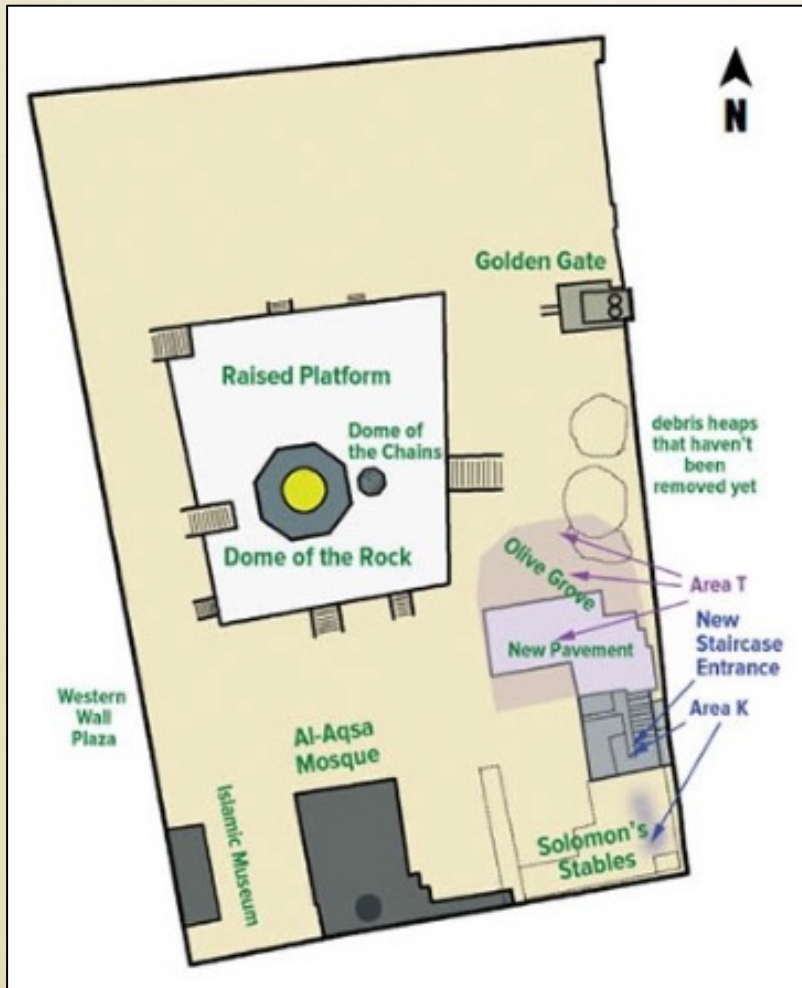

*What We Learned from Sifting the Earth of the Temple Mount  
by Dr. Gabriel Barkay and Zachi Dvira, TheTorah.com*



# WEIGHING THE ARGUMENTS

*Prima facie* - true, valid, or sufficient at first impression. Self-evident. Legally sufficient to establish a fact or a case unless disproved.

- Past arguments relied solely on circumstantial evidence.
- It was not believed that there was any prima facie evidence (i.e., landmarks) to establish definitively the temple location...

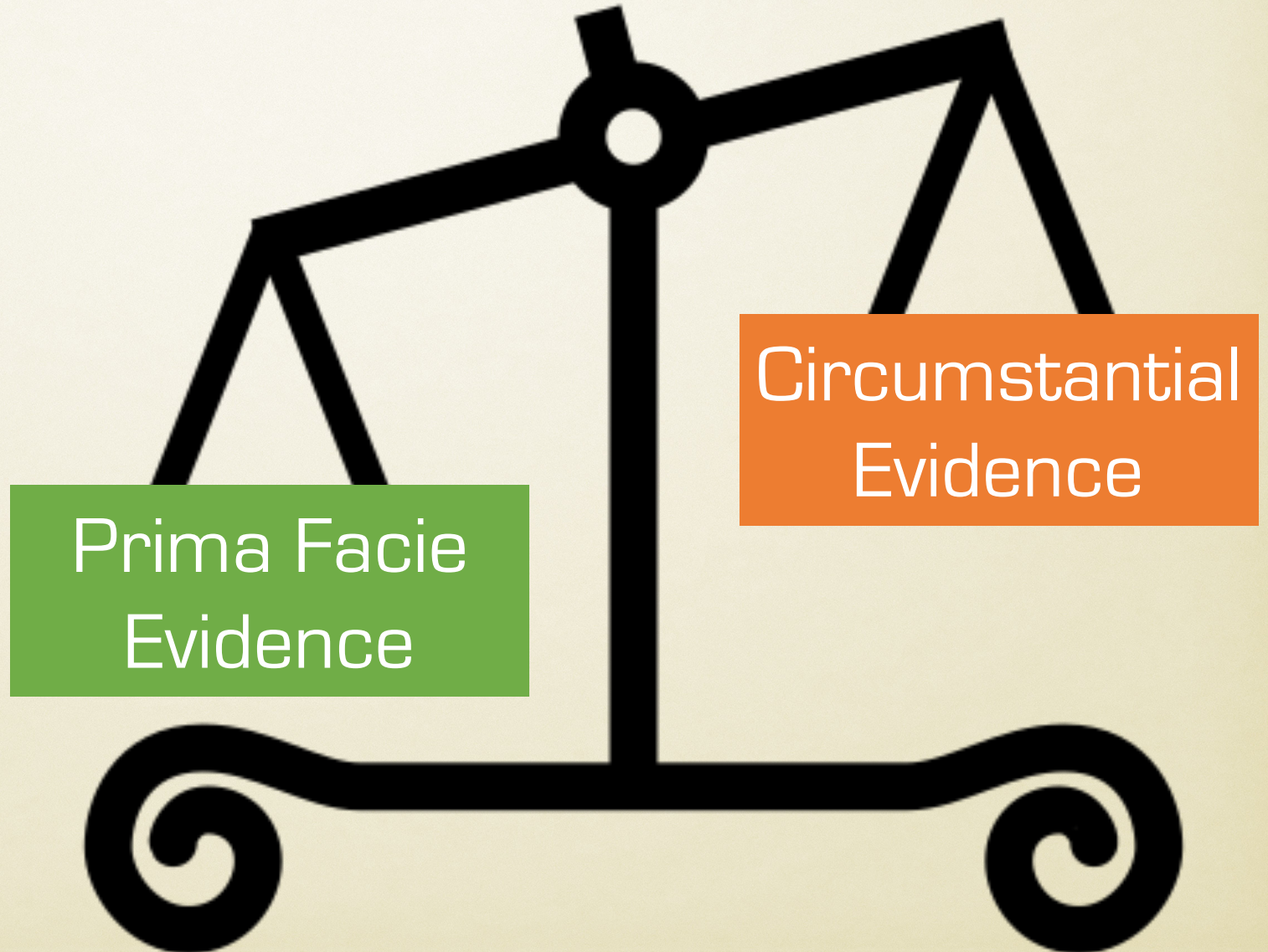



# END TIMES BEREAN YouTube CHANNEL



**The Temple Revealed - Jewish Temple Location Found! by Christian Widener**

380K views • 4 years ago



**The Jewish Temple in Jerusalem - Where it Was and Wasn't**

43K views • 3 years ago





CHRISTIAN@ENDTIMESBEREAN.COM

Download a FREE pdf of  
*The Temple Revealed* at:

ENDTIMESBEREAN.COM



*Also available at Amazon.com*

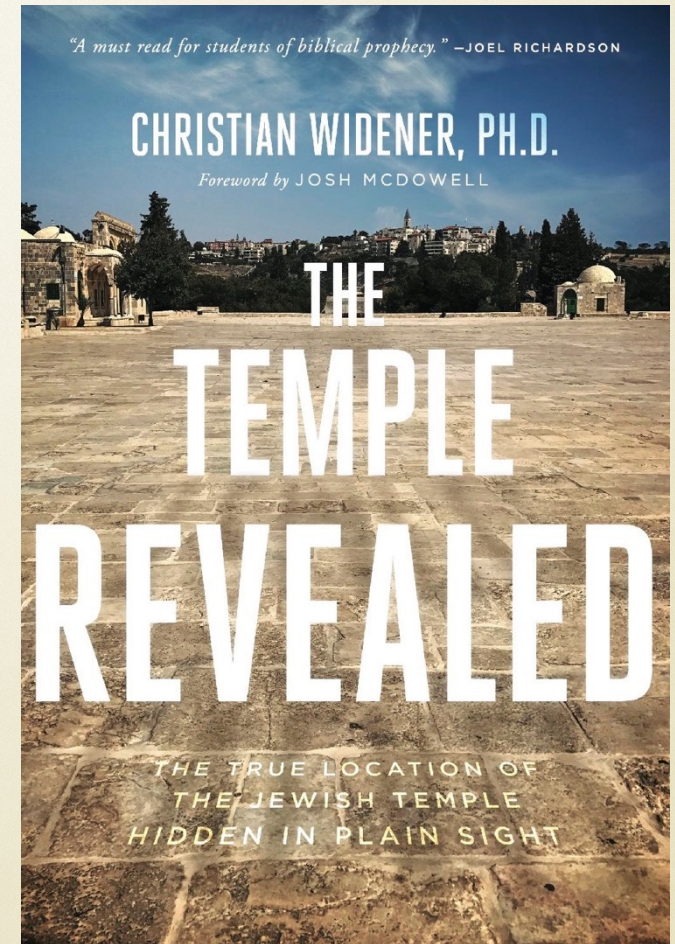

THE TEMPLE REVEALED COVER